

**THE COUNCIL OF THE BOROUGH OF MILTON KEYNES
(THE COUNCIL OF THE BOROUGH OF MILTON KEYNES)
(CENTRAL MILTON KEYNES) (ON-STREET STANDARD RATE
PAY AND DISPLAY AND PAY BY MOBILE PHONE PARKING
PLACES AND VARIOUS PERMITS) ORDER 2002) VARIATION
ORDER 2015**

The Council of the Borough of Milton Keynes (hereinafter referred to as "the Council") in exercise of their powers under Sections 45, 46, 49 and 53 and part IV of Schedule 9 of the Road Traffic Regulation Act 1984, ("the Act of 1984") and of all other enabling powers, and after consultation with the Chief Officer of Police in accordance with Part III of Schedule 9 to the Act of 1984, hereby makes the following Order:-

PART 1

IMPLEMENTATION AND CITATION

1. This Order shall come into operation on the 18th day of May 2015 and may be cited as "The Council of the Borough of Milton Keynes (The Council of the Borough of Milton Keynes) (Central Milton Keynes) (On-Street Standard Rate Pay and Display and Pay by Mobile Phone and Various Permits) Order 2002) Variation Order 2015".
2. Any reference in this Order to any enactment shall be construed as a reference to that enactment as amended by any subsequent enactment.

PART 2

VARIATIONS

3. The Council of the Borough of Milton Keynes (Central Milton Keynes) (On-Street Standard Rate Pay and Display and Pay by Mobile Phone and Various Permits) Order 2002 ("The Principal Order") is varied as provided by the following provisions of this Order:-

4. The title SCHEDULE 1 of the Principal Order is revoked and replaced with the following:-

SCHEDULE 1

**ON-STREET STANDARD RATE PAY AND DISPLAY AND PAY BY
MOBILE PHONE PARKING PLACES**

**EXCEPT WITHIN THE MARKED BICYCLE / MOTOR CYCLE AND
DISABLED PERSONS' PARKING PLACES**

BETWEEN 7.00AM AND 6.00PM ON EVERY DAY OF THE WEEK

5. The title SCHEDULE 1A of the Principal Order is revoked and replaced with the following:-

SCHEDULE 1A

**ON-STREET STANDARD RATE PAY AND DISPLAY AND PAY BY
MOBILE PHONE PARKING PLACES**

**EXCEPT WITHIN THE MARKED BICYCLE / MOTOR CYCLE AND
DISABLED PERSONS' PARKING PLACES**

BETWEEN 7.00AM AND 6.00PM ON EVERY DAY OF THE WEEK

6. The title SCHEDULE 2 of the Principal Order is revoked and replaced with the following:-

SCHEDULE 2

**ON-STREET STANDARD RATE PAY AND DISPLAY AND PAY BY
MOBILE PHONE PARKING PLACES**

**EXCEPT WITHIN THE MARKED BICYCLE / MOTOR CYCLE AND
DISABLED PERSONS' PARKING PLACES**

BETWEEN 8.30AM AND 6.00PM ON EVERY DAY OF THE WEEK

7. The title SCHEDULE 2A of the Principal Order is revoked and replaced with the following:-

SCHEDULE 2A

**ON-STREET STANDARD RATE PAY AND DISPLAY AND PAY BY
MOBILE PHONE PARKING PLACES**

**EXCEPT WITHIN THE MARKED BICYCLE / MOTOR CYCLE AND
DISABLED PERSONS' PARKING PLACES**

BETWEEN 8.30AM AND 6.00PM ON EVERY DAY OF THE WEEK

8. The title SCHEDULE 3 of the Principal Order is revoked and replaced with the following:-

SCHEDULE 3

**ON-STREET STANDARD RATE PAY AND DISPLAY AND PAY BY
MOBILE PHONE PARKING PLACES**

**EXCEPT WITHIN THE MARKED BICYCLE / MOTOR CYCLE AND
DISABLED PERSONS' PARKING PLACES**

BETWEEN 7.00AM AND 6.00PM ON EVERY DAY OF THE WEEK

9. The following new title SCHEDULE 2B is inserted into the Principal Order:-

SCHEDULE 2B

**ON-STREET STANDARD RATE PAY AND DISPLAY AND PAY BY
MOBILE PHONE PARKING PLACES**

**EXCEPT WITHIN THE MARKED BICYCLE / MOTOR CYCLE AND
DISABLED PERSONS' PARKING PLACES**

BETWEEN 9.15AM AND 6.00PM ON EVERY DAY OF THE WEEK

10. The following items are revoked from Schedule 2 and inserted into Schedule 2B of the Principal Order:-

SILBURY BOULEVARD

THE NORTH-WEST VEHICULAR ACCESSWAY – NORTH-WEST SIDE

PS49c From the north-eastern kerb line of North Second Street to the south-western side of the porte cochere north-east of North Second Street

SILBURY BOULEVARD

THE NORTH-WEST VEHICULAR ACCESSWAY – SOUTH-EAST SIDE

PS49i From the north-eastern kerb line of North Second Street to the south-western side of the porte cochere north-east of North Second Street

SILBURY BOULEVARD

THE SOUTH-EAST VEHICULAR ACCESSWAY – NORTH-WEST SIDE

PS105a From the north-eastern kerb line of Upper Second Street to the south-western side of the porte cochere north-east of Upper Second Street

SILBURY BOULEVARD

THE SOUTH-EAST VEHICULAR ACCESSWAY – SOUTH-EAST SIDE

PS105b From the north-eastern kerb line of Upper Second Street to the south-western side of the porte cochere north-east of Upper Second Street

MIDSUMMER BOULEVARD

THE NORTH-WEST VEHICULAR ACCESSWAY – NORTH-WEST SIDE

PS56c From the north-eastern kerb line of the south-west side of the porte cochere situated north-east of Upper Second Street for a distance of 26.7 metres in a south-westerly direction

MIDSUMMER BOULEVARD

THE NORTH-WEST VEHICULAR ACCESSWAY – SOUTH-EAST SIDE

PS56f From the north-eastern kerb line of Upper Second Street to the south-western side of the porte cochere north-east of Upper Second Street

MIDSUMMER BOULEVARD

THE SOUTH-EAST VEHICULAR ACCESSWAY – NORTH-WEST SIDE

PS118a From the north-eastern kerb line of Lower Second Street to the south-western side of the porte cochere north-east of Lower Second Street

MIDSUMMER BOULEVARD

THE SOUTH-EAST VEHICULAR ACCESSWAY – SOUTH-EAST SIDE

PS118b From the north-eastern kerb line of Lower Second Street to the south-western side of the porte cochere north-east of Lower Second Street

11. The following items are inserted into Schedule 1 of the Principal Order:-

WITAN GATE (EAST SIDE)

THE NORTH-EAST VEHICULAR ACCESSWAY – NORTH-EAST SIDE

PS123a Between the access road from Witan Gate (between Silbury Boulevard and H5 Portway) and Silbury Boulevard

WITAN GATE (EAST SIDE)

THE NORTH-EAST VEHICULAR ACCESSWAY – SOUTH-WEST SIDE

PS123b Between the access road from Witan Gate (between Silbury Boulevard and H5 Portway) and Silbury Boulevard

WITAN GATE (EAST SIDE)

THE SOUTH-WEST VEHICULAR ACCESSWAY – NORTH-EAST SIDE

PS123c Between the access road from Witan Gate (between Silbury Boulevard and H5 Portway) and Silbury Boulevard

WITAN GATE (EAST SIDE)

THE SOUTH-WEST VEHICULAR ACCESSWAY – SOUTH-WEST SIDE

PS123d Between the access road from Witan Gate (between Silbury Boulevard and H5 Portway) and Silbury Boulevard

NORTH ROW

THE SOUTH-EAST VEHICULAR ACCESSWAY – SOUTH-EAST SIDE

PS124 From the north-east side of the porte cochere (situated between North Tenth Street and Secklow Gate) to Secklow Gate

AVEBURY BOULEVARD

THE NORTH-WEST VEHICULAR ACCESSWAY – NORTH-WEST SIDE

PS125a From Lower Ninth Street to the south-west side of the porte cochere situated between Lower Ninth Street and Lower Tenth Street

AVEBURY BOULEVARD

THE NORTH-WEST VEHICULAR ACCESSWAY – SOUTH-EAST SIDE

PS125b From Lower Ninth Street to the south-west side of the porte cochere situated between Lower Ninth Street and Lower Tenth Street

AVEBURY BOULEVARD

THE NORTH-WEST VEHICULAR ACCESSWAY – NORTH-WEST SIDE

PS126a From the north-east side of the porte cochere (situated between Lower Ninth Street and Lower Tenth Street) to Lower Tenth Street

AVEBURY BOULEVARD

THE NORTH-WEST VEHICULAR ACCESSWAY – SOUTH-EAST SIDE

PS126b From the north-east side of the porte cochere (situated between Lower Ninth Street and Lower Tenth Street) to Lower Tenth Street

SILBURY BOULEVARD

THE NORTH-WEST VEHICULAR ACCESSWAY – NORTH-WEST SIDE

PS127a From North Thirteenth Street to the south-west side of the porte cochere situated between North Thirteenth Street and North Fourteenth Street

SILBURY BOULEVARD

THE NORTH-WEST VEHICULAR ACCESSWAY – SOUTH-WEST SIDE

PS127b From North Thirteenth Street to the south-west side of the porte cochere situated between North Thirteenth Street and North Fourteenth Street

SILBURY BOULEVARD

THE NORTH-WEST VEHICULAR ACCESSWAY – NORTH-WEST SIDE

PS128a From the north-east side of the porte cochere (situated between North Thirteenth Street and North Fourteenth Street) to North Fourteenth Street

SILBURY BOULEVARD

THE NORTH-WEST VEHICULAR ACCESSWAY – SOUTH-WEST SIDE

PS128b From the north-east side of the porte cochere (situated between North Thirteenth Street and North Fourteenth Street) to North Fourteenth Street

12. The following items are inserted into Schedule 2 of the Principal Order:-

SILBURY BOULEVARD

THE SOUTH-EAST VEHICUALR ACCESSWAY – NORTH-WEST SIDE

PS129a From Grafton Gate to the south-west side of the porte cochere (situated between Grafton Gate and Upper Second Street)

SILBURY BOULEVARD

THE SOUTH-EAST VEHICUALR ACCESSWAY – NORTH-WEST SIDE

PS129b From Grafton Gate to the south-west side of the porte cochere (situated between Grafton Gate and Upper Second Street)

13. The following items are inserted into Schedule 3 of the Principal Order:-

SILBURY BOULEVARD

THE SOUTH-EAST VEHICUALR ACCESSWAY – NORTH-WEST SIDE

LP51a From Grafton Gate to the south-west side of the porte cochere (situated between Grafton Gate and Upper Second Street)

SILBURY BOULEVARD

THE SOUTH-EAST VEHICUALR ACCESSWAY – NORTH-WEST SIDE

LP51b From Grafton Gate to the south-west side of the porte cochere (situated between Grafton Gate and Upper Second Street)

14. SCHEDULE 6 of the Principal Order is revoked and replaced with:-

	PERMIT TYPE	PERIOD	CHARGE	CODE
1.	Employee Permit (Full-Time) <u>PERMIT FOR PLACES SPECIFIED IN SCHEDULES 1, 1A, 2, 2A, 2B, 3, 4 AND 4A</u>	1 month 2 months 3 months 4 months 5 months 6 months 7 months 8 months 9 months 10 months 11 months 12 months	£37.50 £75.00 £112.50 £150.00 £187.50 £225.00 £262.50 £300.00 £337.50 £375.00 £412.50 £450.00	E1
	PERMIT TYPE	Sessions	Monthly	Yearly
2.	Employee Permit (Part-time) <u>PERMIT FOR PLACES SPECIFIED IN SCHEDULES 1, 1A, 2, 2A, 2B, 3, 4 AND 4A</u> CODE = E1	1 x £1.00 x 4 weeks 2 x £1.00 x 4 weeks 3 x £1.00 x 4 weeks 4 x £1.00 x 4 weeks 5 x £1.00 x 4 weeks 6 x £1.00 x 4 weeks 7 x £1.00 x 4 weeks 8 x £1.00 x 4 weeks 9 x £1.00 x 4 weeks 10 x £1.00 x 4 weeks 11 x £1.00 x 4 weeks 12 x £1.00 x 4 weeks	£4.00 £8.00 £12.00 £16.00 £20.00 £24.00 £28.00 £32.00 £36.00 £40.00 £44.00 £48.00	£48.00 £96.00 £144.00 £192.00 £240.00 £288.00 £336.00 £384.00 £432.00 £480.00 £528.00 £576.00
	SCRATCH-CARD	PERIOD	CHARGE	CODE
3.	Employee Permit Scratch Card (full day) <u>PERMIT FOR PLACES SPECIFIED IN SCHEDULES 1, 1A, 2, 2A, 2B, 3, 4 AND 4A</u>	1 day	£2.00	E1
	SCRATCH-CARD	PERIOD	CHARGE	CODE
4.	Employee Permit Scratch Card (half day) <u>PERMIT FOR PLACES SPECIFIED IN SCHEDULES 1, 1A, 2, 2A, 2B, 3, 4 AND 4A</u>	5 hours	£1.00	E1
	PERMIT TYPE	PERIOD	CHARGE	CODE
5.	Residents permit	Annual	FREE	R1

	Carers Permit	Annual	FREE	M
	Residents Visitors Permit	Annual	FREE	R1
	<u>PERMITS FOR PLACES SPECIFIED IN SCHEDULES 1, 1A, 2A AND 4A</u>			
	<u>SCRATCH-CARD</u>	<u>PERIOD</u>	<u>CHARGE</u>	<u>CODE</u>
8.	Resident Visitors Permit Scratch-Card (up to 50 individual scratch-cards) <u>PERMIT FOR PLACES SPECIFIED IN SCHEDULES 1, 1A, 2A AND 4A</u>	1 day	FREE	R1
9.	Replacement Resident Visitors Permit Scratch-Card (for each individual scratch-card above 50) <u>PERMIT FOR PLACES SPECIFIED IN SCHEDULES 1, 1A, 2A AND 4A</u>	1 day	£2.00	R1
	<u>PERMIT</u>	<u>PERIOD</u>	<u>CHARGE</u>	<u>CODE</u>
10.	Car Share Permit <u>PERMIT FOR PLACES SPECIFIED IN SCHEDULES 1, 1A, 2, 2A, 2B, 3, 4 AND 4A</u>	12 months	FREE	CS
	<u>PERMIT</u>	<u>PERIOD</u>	<u>CHARGE</u>	<u>CODE</u>
11.	Low Emission Vehicle Permit <u>PERMIT FOR PLACES SPECIFIED IN SCHEDULES 1, 1A, 2, 2A, 2B, 3, 4 AND 4A</u>	12 months	£75.00	G
	<u>SCRATCH-CARD</u>	<u>PERIOD</u>	<u>CHARGE</u>	<u>CODE</u>
12.	Hotel and Conference Attendee Permit Scratch Card <u>SCHEDULES 1, 1A, 2, 2A, 2B, 3, 4 AND 4A</u>	1 day	£5.00	H1
13.	Replacement Permits	For the unused amount of the permit being replaced		£5.00

PART 3

REVOCATIONS

15. The following Order is HEREBY REVOKED to the extent stated below:-

THE COUNCIL OF THE BOROUGH OF MILTON KEYNES) (CENTRAL MILTON KEYNES) (ON-STREET STANDARD RATE PAY AND

**DISPLAY AND PAY BY MOBILE PHONE PARKING PLACES AND
VARIOUS PERMITS) ORDER 2002**

The following items from Schedule 3 are HEREBY REVOKED IN THEIR
ENTIRETY;

LP12c, LP12i, LP19c, LP19f, LP33a, LP33b, LP46a and LP46b

**THE COMMON SEAL of the COUNCIL
OF THE BOROUGH OF MILTON
KEYNES** was hereunto affixed this
12th day of May 2015 in the presence
of:-

.....
HEAD OF LEGAL SERVICES



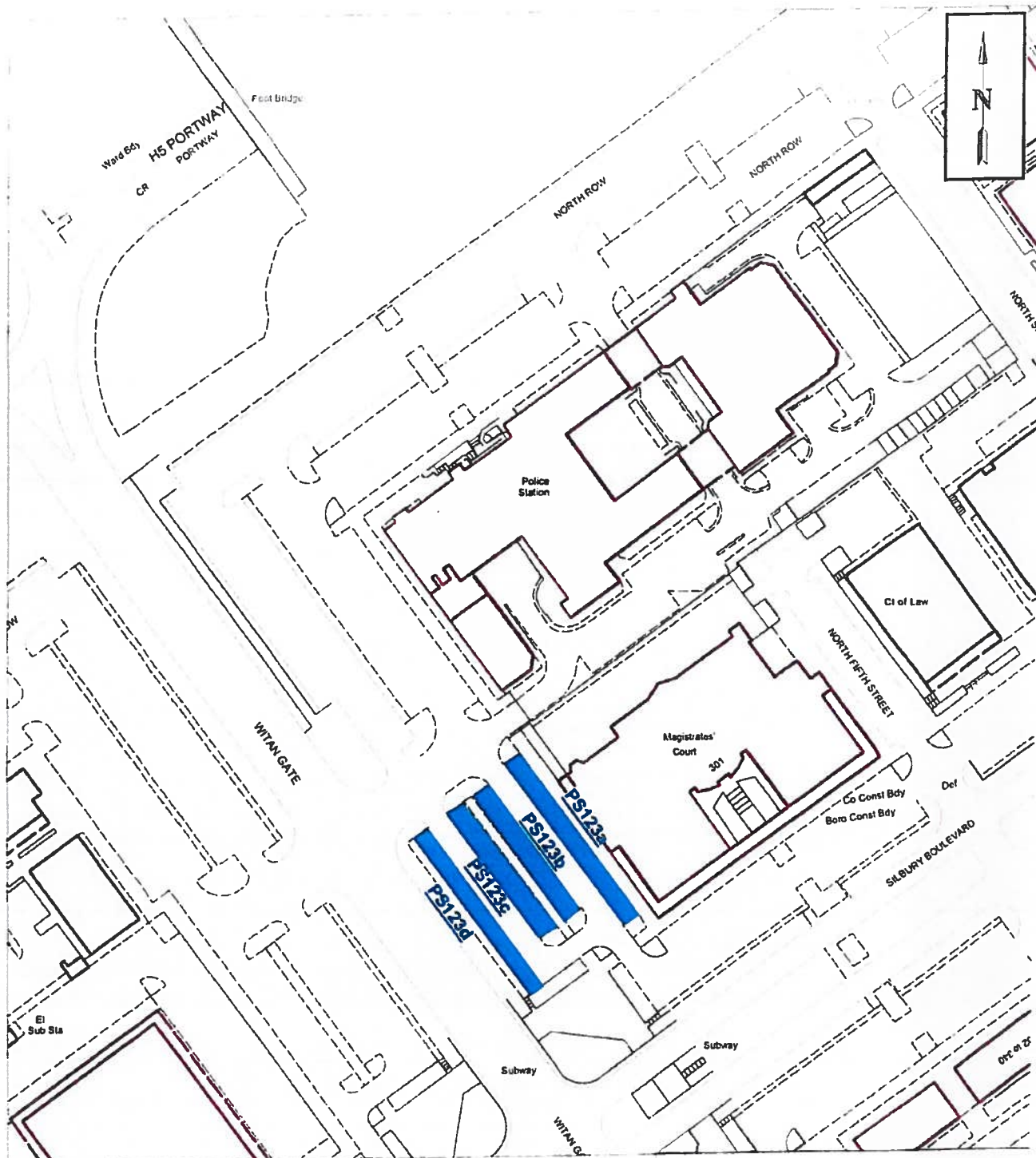

Standard rate pay and display parking places

PS123a

TRO reference

0 30.00



meters

Scale: 1:1,000

Map referred to in the Council of the Borough of Milton Keynes (The Council of the Borough of Milton Keynes) (Central Milton Keynes) (On-Street Standard Rate Pay and Display and Pay by Mobile Phone and Various Permits) Order 2002) Variation Order 2015

Map 1

The Common Seal of the Council of the Borough of Milton Keynes was hereunto affixed in the presence of:

[Signature]

HEAD OF LEGAL SERVICES



22336

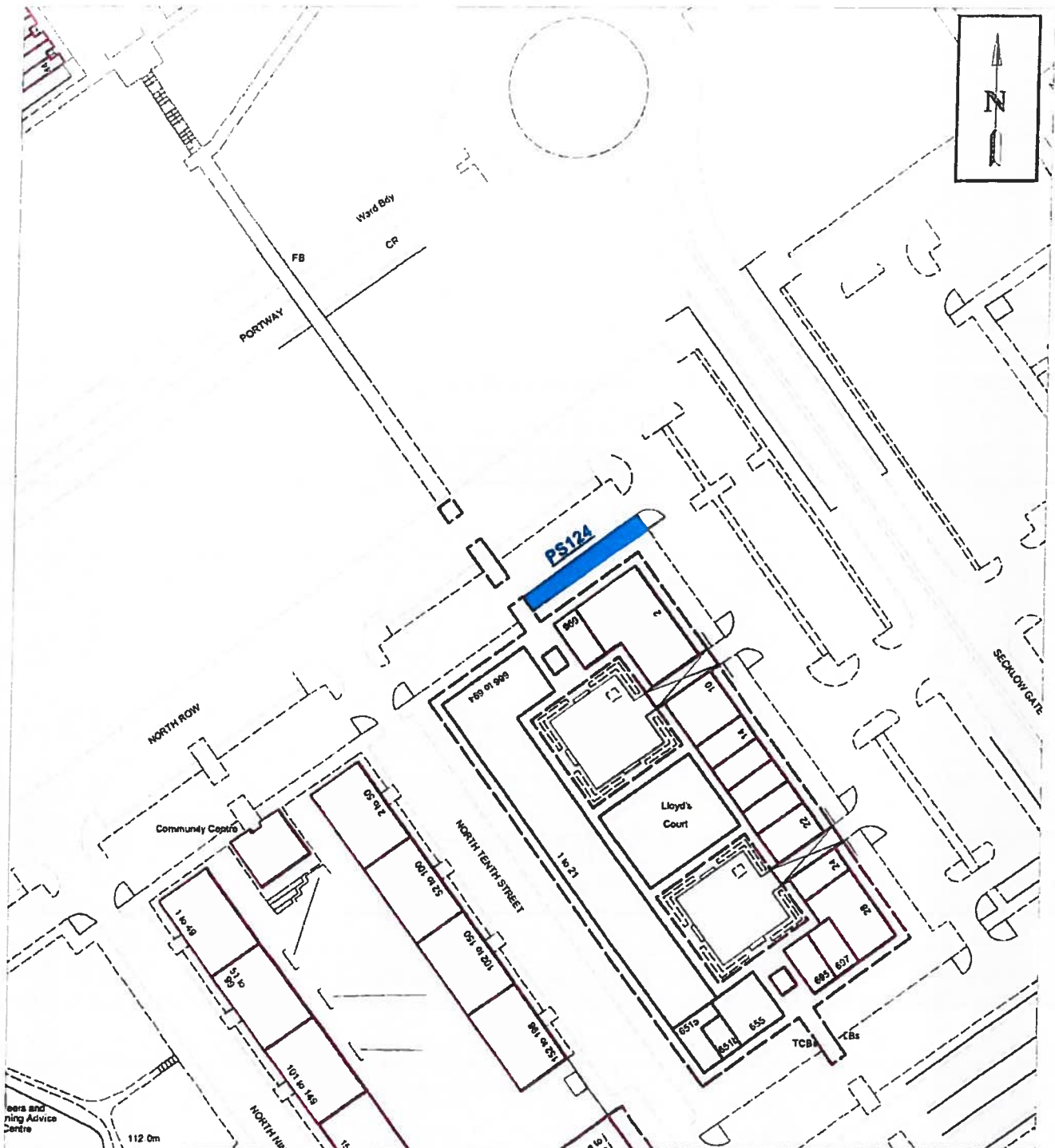

Standard rate pay and display parking places

PS124

TRO reference

Map referred to in the Council of the Borough of Milton Keynes (The Council of the Borough of Milton Keynes) (Central Milton Keynes) (On-Street Standard Rate Pay and Display and Pay by Mobile Phone and Various Permits) Order 2002) Variation Order 2015

Map 2

The Common Seal of the Council of the Borough of Milton Keynes was hereunto affixed in the presence of:



 HEAD OF LEGAL SERVICES

0 30.00

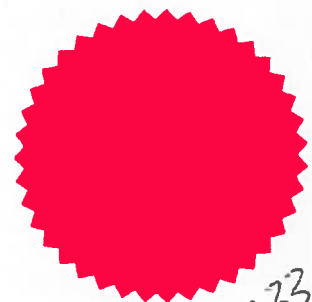

meters

Scale: 1:1,000



22336

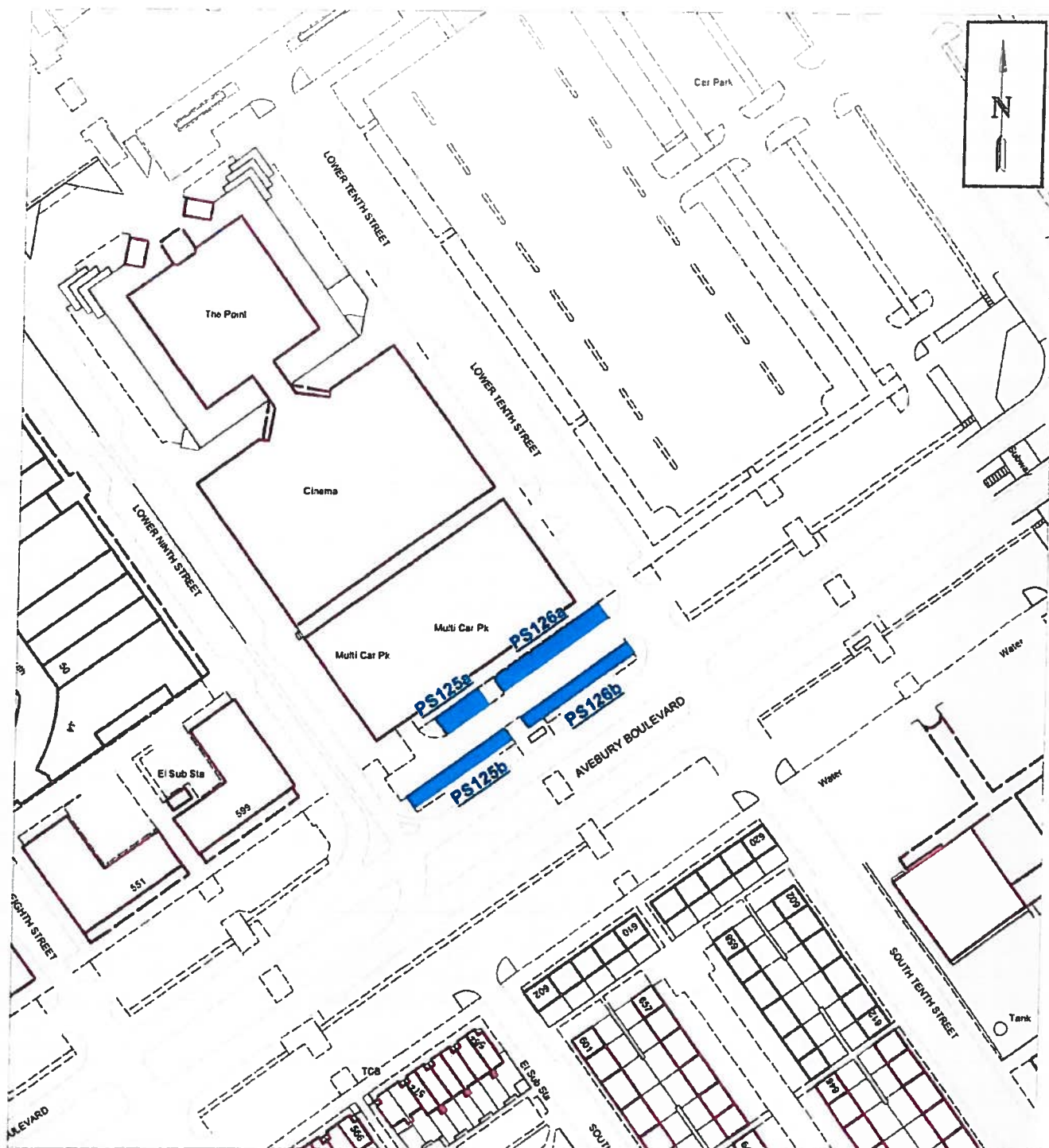

Standard rate pay and display parking places

PS125a

TRO reference

Map referred to in the Council of the Borough of Milton Keynes (The Council of the Borough of Milton Keynes) (Central Milton Keynes) (On-Street Standard Rate Pay and Display and Pay by Mobile Phone and Various Permits) Order 2002) Variation Order 2015

Map 3

The Common Seal of the Council of the Borough of Milton Keynes was hereunto affixed in the presence of:

HEAD OF LEGAL SERVICES

0 30.00



meters

Scale: 1:1,000

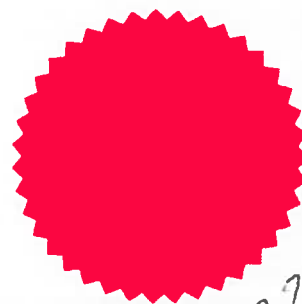

22336

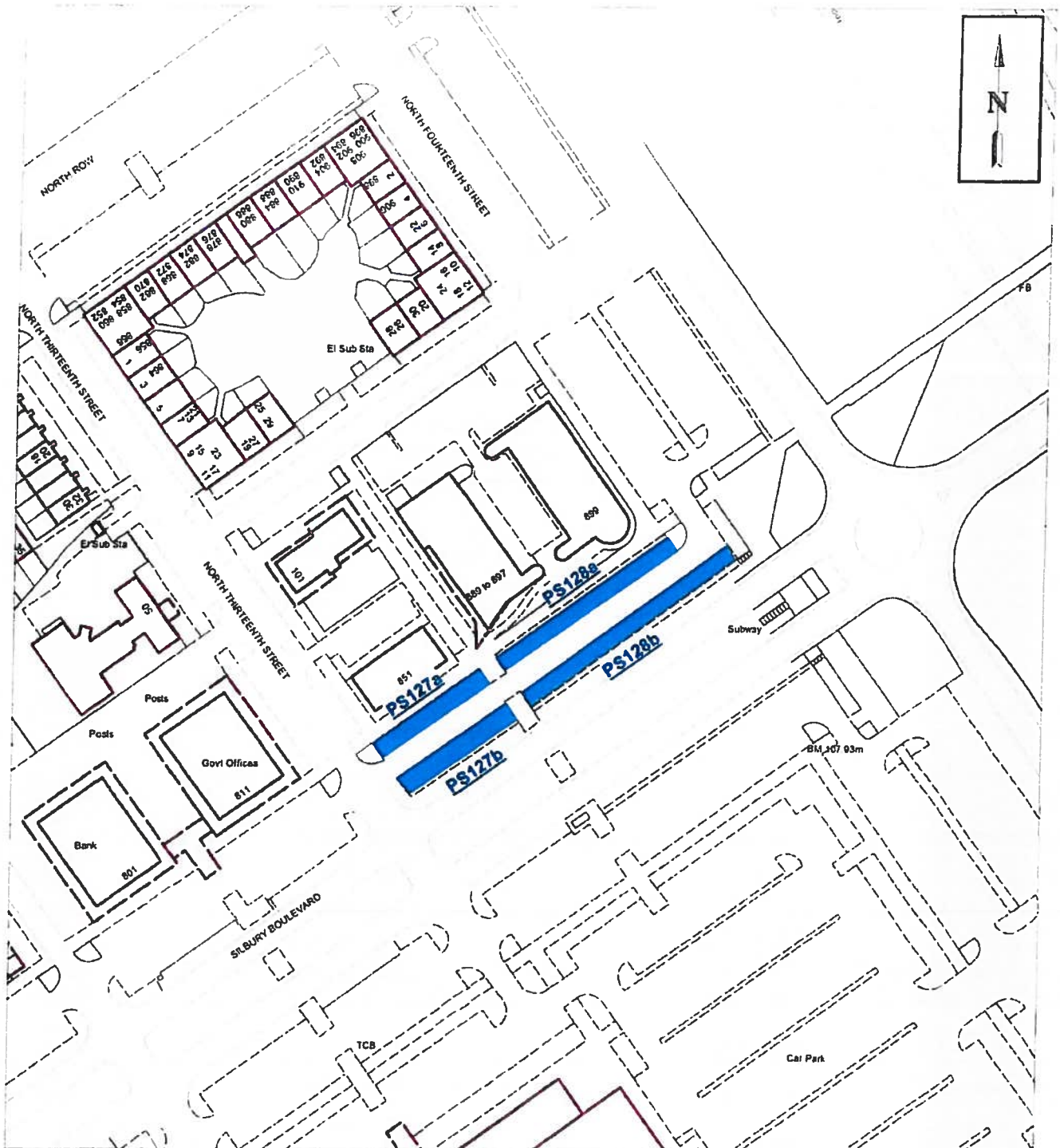

Standard rate pay and display parking places

PS127a

TRO reference

Map referred to in the Council of the Borough of Milton Keynes (The Council of the Borough of Milton Keynes) (Central Milton Keynes) (On-Street Standard Rate Pay and Display and Pay by Mobile Phone and Various Permits) Order 2002) Variation Order 2015

Map 4

The Common Seal of the Council of the Borough of Milton Keynes was hereunto affixed in the presence of:

 HEAD OF LEGAL SERVICES

0 30.00



meters

Scale: 1:1,000



22336

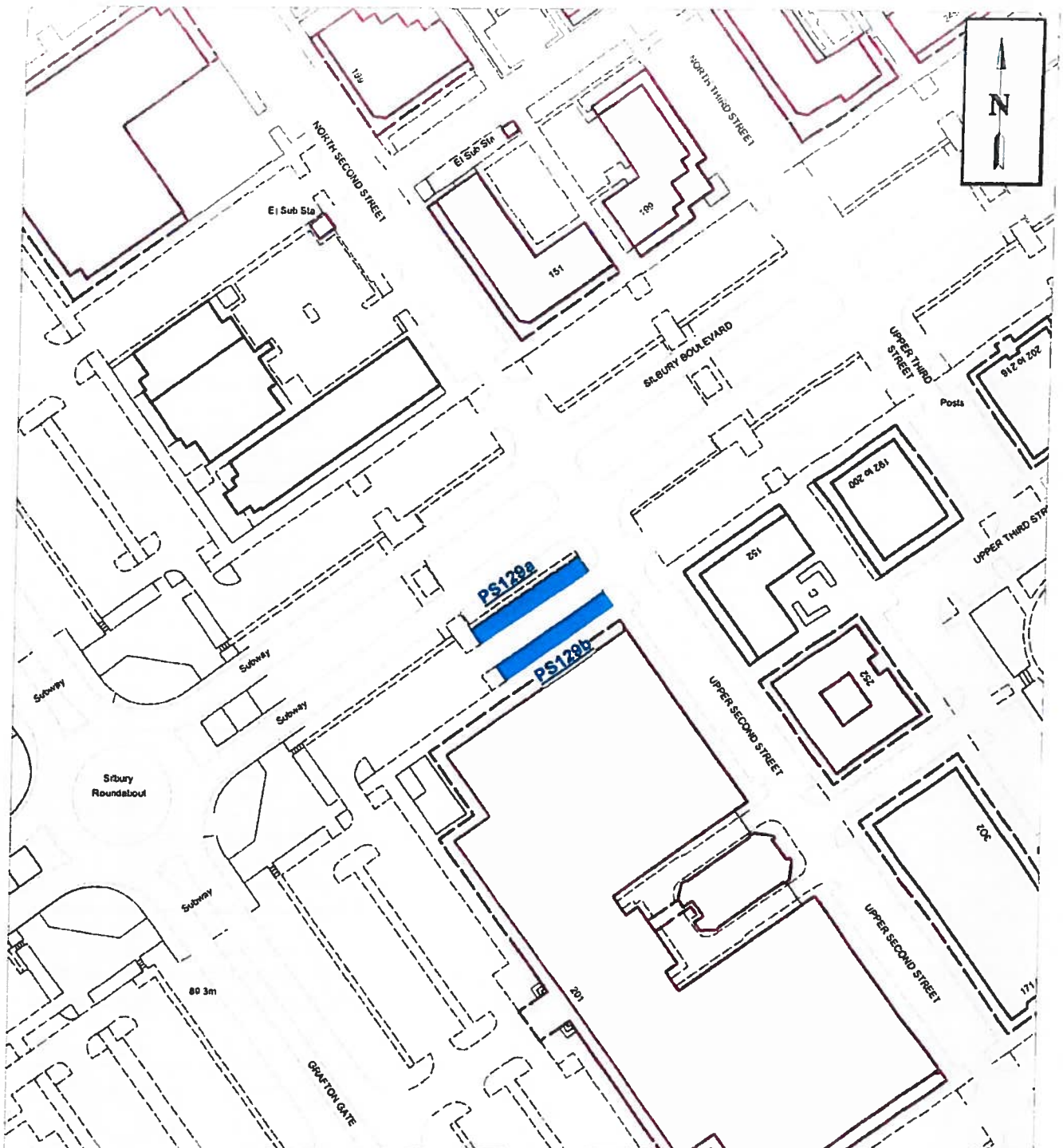

Standard rate pay and display parking places

PS129a

TRO reference

Map referred to in the Council of the Borough of Milton Keynes (The Council of the Borough of Milton Keynes) (Central Milton Keynes) (On-Street Standard Rate Pay and Display and Pay by Mobile Phone and Various Permits) Order 2002) Variation Order 2015

Map 5

The Common Seal of the Council of the Borough of Milton Keynes was hereunto affixed in the presence of:

HEAD OF LEGAL SERVICES

0 30.00



meters

Scale: 1:1,000



22336

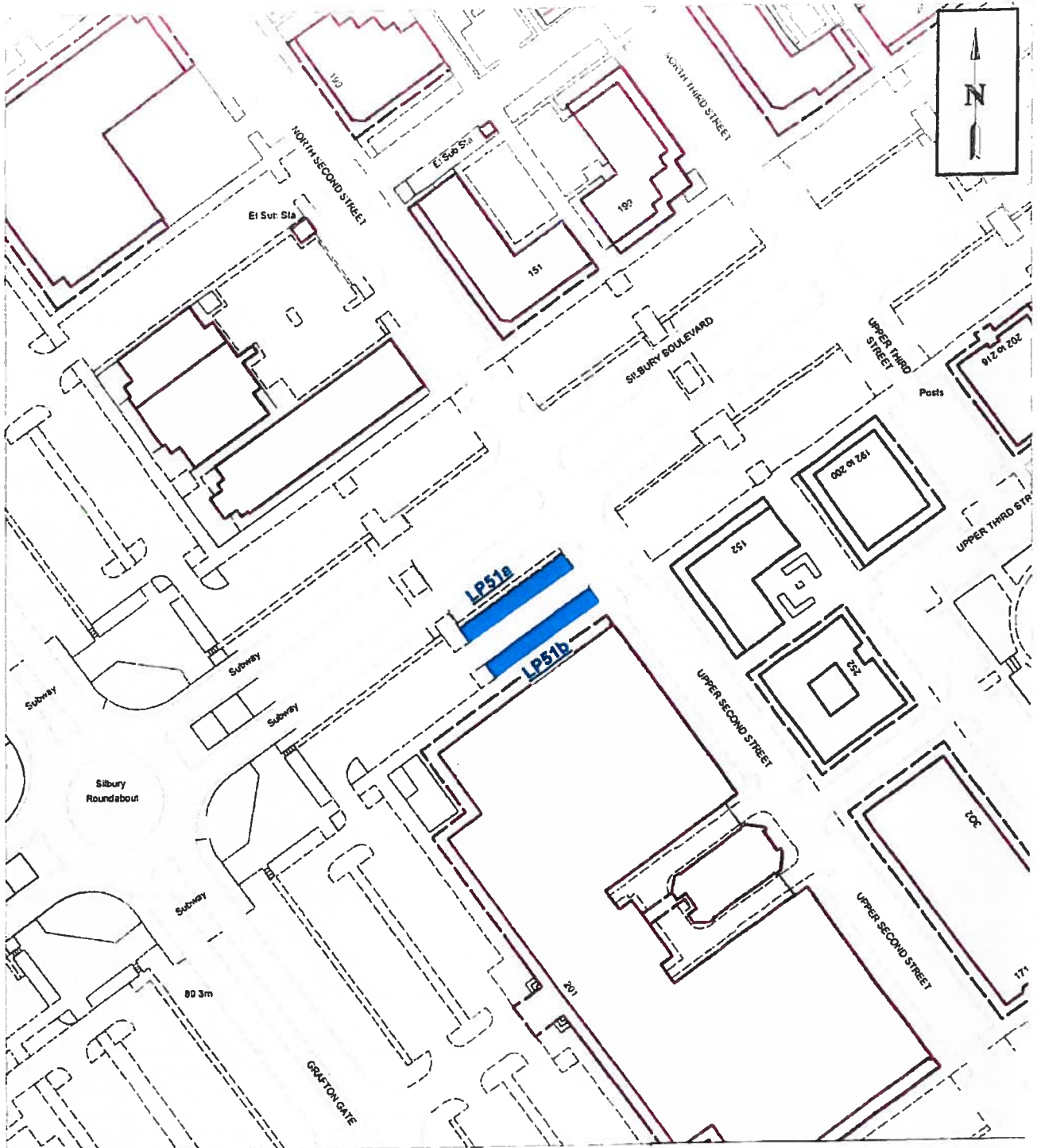

Limited parking for permit holders parking places

LP51a

TRO reference

Map referred to in the Council of the Borough of Milton Keynes (The Council of the Borough of Milton Keynes) (Central Milton Keynes) (On-Street Standard Rate Pay and Display and Pay by Mobile Phone and Various Permits) Order 2002) Variation Order 2015

Map 6

The Common Seal of the Council of the Borough of Milton Keynes was hereunto affixed in the presence of:

[Handwritten signature]

HEAD OF LEGAL SERVICES

0 30.00



meters

Scale: 1:1,000



22336